









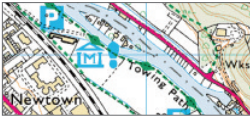

Licence Free

View, print & save as image

Current Mapping

	View	Roam	Print / Save as image A4	Print / Save as image A3
 UKMap Detail 1:1250 (Urban)	Free	Free	£23.73	£51.13
 OS Detail 1:1,250 (Urban) OS Detail 1:2,500 (Rural) OS Detail 1:10,000 (Moorland)	£1.35 £1.35 £1.35	£0.13 £0.13 £0.13	£27.92 £27.92 £27.92	£60.17 £27.92 £27.92
	View	Roam	Print / Save as image	
 Street + (1:10,000)	Free	Free	from £13.79	
 Street (1:20,000)	Free	Free	from £0.93	
 Explorer (1:25,000)	Free	Free	from £0.71	
 Town (1:50,000)	Free	Free	from £0.09	
 Road (1:200,000)	Free	Free	£2.33	
 GB (1:10,000)	Free	Free	£2.33	
	View	Roam	Print / Save as image	
 Birds Eye Imagery (10cm)	Free	Free	from £10.00 (for 5 images)	
 Aerial Photography (10cm) Aerial Photography (25cm)	Free Free	Free Free	from £14.00 from £7.00	

Licence Free

View, print & save as image

Historical Mapping



Historical Mapping
(various scales)

View

Roam

Save as PDF

N/A

N/A

from £10.00

Export data

Current Mapping



UKMap Detail 1:1250 (Urban)

1Ha

5Ha

10Ha

20Ha

£11.90

£37.27

£68.96

£126.26



OS Detail 1:1,250 (Urban)

£14.00

£43.85

£81.14

£148.64



OS Detail 1:2,500 (Rural)

£14.00

£21.46

£56.09

£267.35



OS Detail 1:10,000 (Moorland)

£14.00

£14.46

£16.63

£29.83



Street + (1:10,000)

£13.79

£19.30

£51.96

£205.13

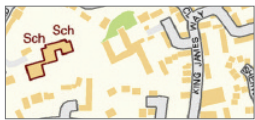

OS Detail 1:1,250 (Urban)

£0.93

£4.66

£23.33

£93.35



Explorer (1:25,000)

£3.55

£3.55

£17.75

£71.00



Town (1:50,000)

£0.93

£0.93

£2.33

£9.34

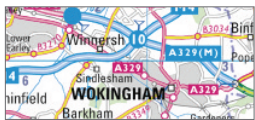

Road (1:200,000)

£2.33

All sizes



GB (1:5,000,000)

£2.33

Licence Free

Export data

Aerial Photography



	1Ha	10Ha	1km ²	5km ²
Aerial Photography (10cm)	£14.00	£34.80	£76.87	£166.72
Aerial Photography (12.5cm)	£14.00	£34.80	£76.87	£166.72
Aerial Photography (25cm)	£7.00	£16.87	£40.69	£88.00



	9km ²	25km ²		
Aerial Photography (50cm)	£101.50	£199.47		
Aerial Photography (1m)	£58.00	£118.60		
Historical Aerial Photography (various)	from £7.50			

3D Models



	10Ha	25Ha	50Ha	1km ²
Zmapping High Detail (Pre-built)	£450.00	£875.00	£1750.00	£3500.00
Zmapping High Detail (Bespoke)	£650.00	£1090.00	£1990.00	£3800.00
Zmapping Medium Detail (Pre-built)	£200.00	£500.00	£1000.00	£2000.00
Zmapping Medium Detail (Bespoke)	£500.00	£715.00	£1240.00	£2300.00
UKMap 3D Data Bundle (Basic Detail)	£161.76	£333.80	£587.09	£978.60

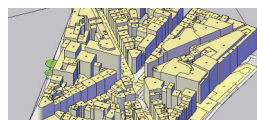

Height Data

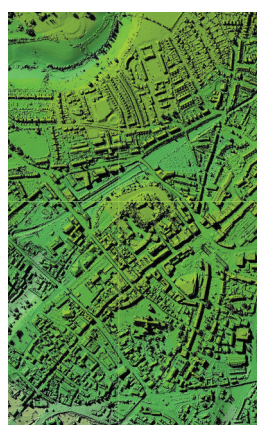

	10Ha	50Ha	1km ²	5km ²
25cm EA DTM (LiDAR)	£175.00	£175.00	£175.00	£875.00
25cm EA DSM (LiDAR)	£175.00	£175.00	£175.00	£875.00
50cm EA DTM (LiDAR)	£150.00	£150.00	£150.00	£750.00
50cm EA DSM (LiDAR)	£150.00	£150.00	£150.00	£750.00
1m EA DTM (LiDAR)	£125.00	£125.00	£125.00	£625.00
1m EA DSM (LiDAR)	£125.00	£125.00	£125.00	£625.00
2m EA DTM (LiDAR)	£100.00	£100.00	£100.00	£500.00
2m EA DSM (LiDAR)	£100.00	£100.00	£100.00	£500.00
5m NextMap DTM (RADAR)	£10.00	£20.00	£40.00	£200.00
5m NextMap DSM (RADAR)	£10.00	£20.00	£40.00	£200.00

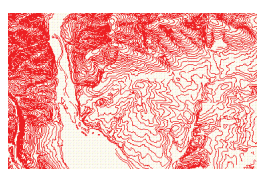

	10Ha	5km ²	25km ²	100km ²
OS Land-Form PROFILE Contours	£30.00	£49.45	£79.90	£149.90
OS Land-Form PANORAMA Contours	£20.00	£25.45	£27.00	£30.00
OS Land-Form PANORAMA DTM	£20.00	£20.00	£25.00	£27.14

Licence Free

Export data

Flood Data

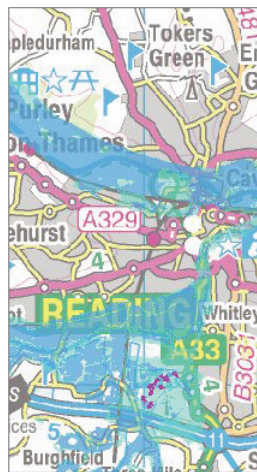

	10Ha	5km ²	25km ²	100km ²
EA Flood Map	£40.00	£60.00	£160.00	£535.00
EA National Flood Risk Assessment	£10.00	£14.00	£34.00	£109.00
EA Detailed River Network	£10.00	£18.00	£58.00	£208.00
EA Source Protection Zones	£10.00	£14.00	£34.00	£109.00
EA Historic Flood Events	£10.00	£18.00	£58.00	£208.00
EA River Quality Data	£10.00	£12.00	£22.00	£59.50
BGS Geological Indicators of Flooding	£5.00	£13.00	£53.00	£203.00
BGS Groundwater Flooding Suseptability	£5.00	£13.00	£53.00	£203.00
RMS Pluvial Flood Data	£40.00	£60.00	£160.00	£535.00

Land Use Constraints Data

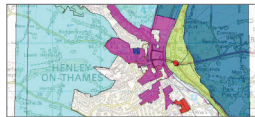

	10Ha	1km ²	5km ²	25km ²
Land Use Constraints Data	£50.00	£69.00	£181.00	£417.00

Local Plan Data



	10Ha	1km ²	5km ²	25km ²
Local Plan Data (incl. Green Belt)	£250.00	£250.00	£350.00	£650.00
Green Belt Data	£49.50	£57.75	£77.55	£136.95

Administrative Data



	10Ha	1km ²	5km ²	25km ²
Boundaries	£10.00	£55.00	£95.00	£295.00



OS Codepoint with Polygons	from £20.00 (low density areas) from £50.00 (low density areas)
----------------------------	--

Historical Mapping



Historical Mapping (1:2,500)	from £240.00
Historical Mapping (1:10,000)	from £150.00
Historic Building Plans	from £60.00

Planning Applications



	10Ha	1km ²	5km ²	25km ²
Planning Applications Barbour ABI	£40.00	£70.00	£90.00	£140.00

Licence Free

Export data continued

Points of interest



	10Ha	1km ²	5km ²	25km ²
Point X - Commercial Services	£45.00	£45.00	£67.50	£180.00
Point X - Education and Health	£15.00	£15.00	£22.50	£60.00
Point X - Manufacturing and Production	£30.00	£30.00	£45.00	£120.00
Point X - Public Infrastructure	£75.00	£75.00	£112.50	£300.00
Point X - Recreational and Environmental	£50.00	£50.00	£75.00	£200.00
Point X - Retail and Eating	£25.00	£25.00	£37.50	£100.00

Other products

Reports

Sitecheck Data	Sitecheck Assess	Sitecheck Review	Sitecheck Flood
from £96.00	from £149.00	from £245.00	from £120.00
Enviroscreen	Utilities Report	Homecheck Flood	Historic Maps with site
from £52.00	from £350.00	£16.15	£135.00
OS Licence	First 5 offices (1-5)	Next 5 offices (6-10)	Next 10 offices (11-20)
PMCL	£54.75	£53.25	£51.50
			Next offices (21-71)
			£50.00

Notes

- 1) Following a map 'View' you have the ability to customise, measure and save. To re-view a save map is **free**.
- 2) The 'Licence Paid' option at the cost of £395.00 annually is recommended if you print more than 1 map per week as it provides you with lower map costs.
- 3) A map 'View' includes 1,350m of free roaming. Each additional 150m roam may incur a charge depending on the mapping layer.
- 4) Map prints at various scales and paper sizes are available, this may alter costs. The price will always be displayed onscreen prior to committing to any chargeable action. Prints can only be made once maps have been viewed first.
- 5) Purchasing an Ordnance Survey Paper Map Copying Licence (PMCL) allows you to print unlimited run-on copies of a map once an original print charge has been paid. Charges are applicable if the licence period has expired. A PMCL is subject to a minimum fee of £54.75 for the 1st office and a maximum fee of £3,655.00 for 72 or more offices.
- 6) This price list provides example pricing for the most popular sizes/selections. To confirm the cost for a specific site, simply log-in to Promap and select the area of interest.
- 7) Prices quoted are exclusive of VAT.
- 8) Promap (Prodat Systems) reserve the right to change prices at anytime. To view 'live' pricing, simply log-in to Promap and select the area of interest.

